

PORTLAND PUBLIC SCHOOLS  
FRANKLIN HIGH SCHOOL  
PORTLAND, OREGON



GRAND OPENING

*September 2nd, 2017*

# THE HISTORICAL MODERNIZATION



## MISSION

Franklin High School engages each and every student with instruction based on both tradition and innovation that broadens and deepens knowledge, increases skills, and inspires confidence. Providing a diverse and supportive environment, our educators, families and community prepare our students for a strong future and appreciation for lifelong learning and service.



## HISTORY

Franklin High School was founded in 1915 and built in 1917. The school is named for Benjamin Franklin, printer, author, scientist, inventor, musician, and revolutionary. The hand carved wooden figure of Franklin welcomes guests in the Performing Arts lobby.



*“Our new school is so open, there are places I can sit with my friends and study, I love it. This place is so great!”*

*Julia Povich  
FHS Student, Class of 2018*

The modernized Franklin High School is a significant step forward in transforming Portland Public School’s facilities into next generation learning environments. The learning spaces have been modernized, reconfigured, and updated with a focus on indoor environmental quality, sustainability, and historic preservation.

- A new fine and performing arts center is the beacon of the modernized campus at the intersection of SE Woodward and 52nd Avenue.
- A dynamic, two-story entry lobby in the historic main building provides students and the community a space to gather, work, and learn.
- A 90-degree realignment of the track and field was completed to accommodate the new athletic / gym and educational facility.
- Repurposed the existing auditorium as the new media center to allow this majestic space to continue to serve the Franklin community.
- The 1915 building was seismically reinforced with over 30 shear walls and structural reinforcement steel.
- Entire facility is fully ADA accessible with new elevators and wheelchair lifts.
- All lights are LED for greater energy efficiency.
- New rooftop solar panels are generating power for the school.

## COMMUNITY INVOLVEMENT - FRANKLIN IS FAMILY

The 2012 Portland Public Schools Bond was the culmination of significant community engagement and input. Public Design Workshops provided students and school communities the opportunity to help shape the master and schematic designs. Design Advisory Groups and Master Planning Committees comprised of students and community stakeholders provided feedback for the PPS Design Teams. The support and involvement of the Community for the modernization included various stakeholder groups including:

- Design Advisory Group that consists of parents, teachers, students, service providers, and the community.
- Franklin Neighborhood Group
- District Staff & Faculty
- Head Start
- Multnomah County
- Schools Uniting Neighborhoods (SUN)
- The Franklin Alumni Association (FAA) raised \$90K to buy bricks for the West/South face of the new gym building. The FAA Association also donated funds for special seats in the grandstands.
- Nike provided funds to help pay for the new track and field as part of the Great Fields Project

*“Genius without education is like silver in the mine.”*

*Ben Franklin*



## DETAILS

1,700 Student  
 280,000 Square Feet  
 \$113 Million

## SCHEDULE

Ground Breaking	May 2015
Construction Start	June 2015
Student Relocation	September 2015
Complete	August 2017
Construction Duration	30.2 Months
Ribbon Cutting	September 2017

## CAREER PATHS

- Engineering / Robotics
- Architecture Design
- Construction
- Health Science / Biomedical
- Information Technology
- Law and Public Service
- Culinary Arts
- Digital Media / Video Production
- Journalism
- Business / Marketing
- Education
- Natural Resources
- Manufacturing

*“This is best high school  
 in the State of Oregon”*

*Abmar McGee  
 FHS Student Class of 2018*

*A dynamic, two-story entry lobby in the historic  
 main building provides students and the community  
 a space to gather, work, and learn.*

## SPACES

Administration	Dance Studio	Media Center
Art 2D & 3D	Day Care Center	Maker Space
Athletics	Early Childhood Education Class- rooms	Synthetic Track & Field
Black Box	Fine and Performing Arts	Student Center
Biomedical	Gymnasium	Student Store
CTE / Career Preparedness	General Education Classrooms	Science and Math Classrooms
Classrooms	Health Science	Sports Medicine
Commons	Health Center	Weight Room
Computer Lab	Law Library / Courtroom	
Counseling	Lecture Halls	
Culinary Arts	Life-skills	

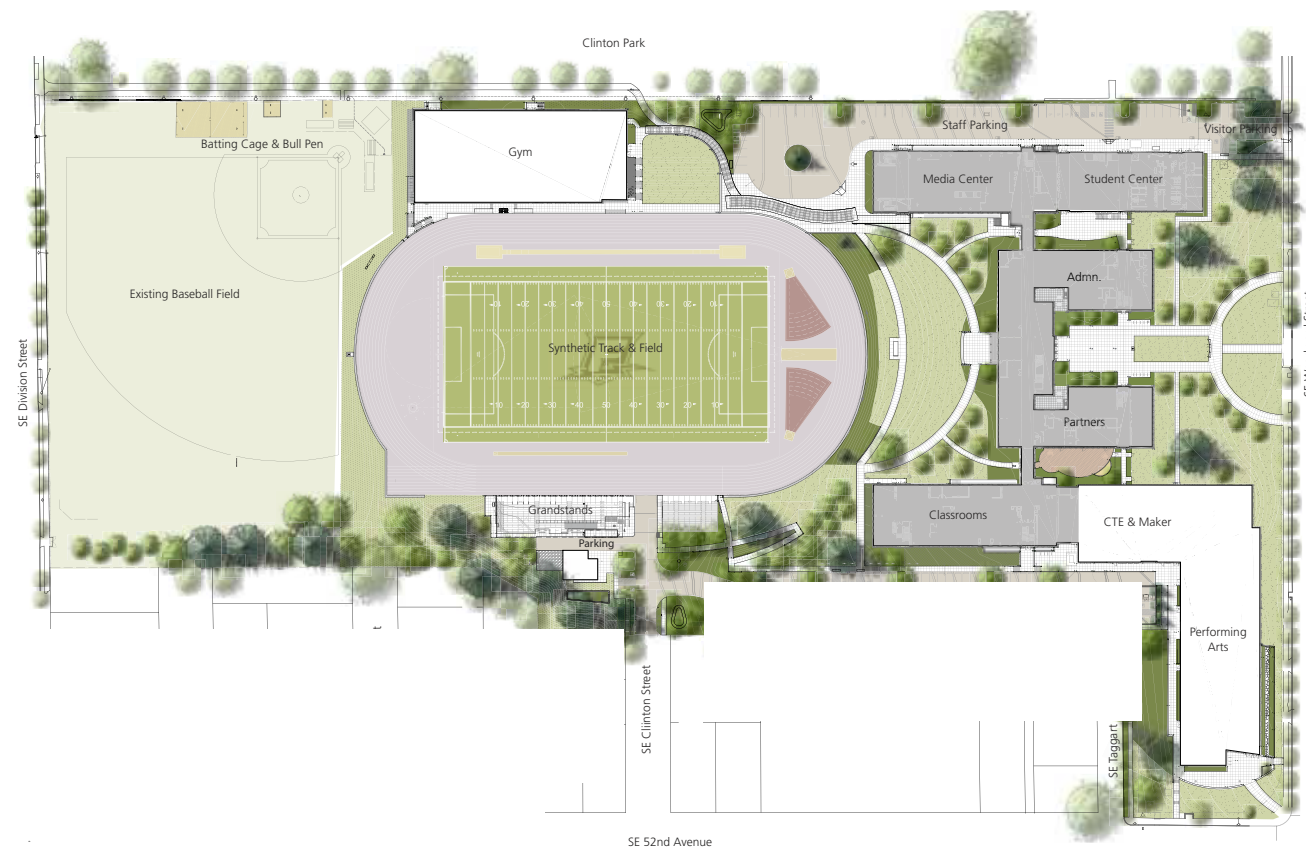

**WEST WING**  
MAKER SPACE &  
PERFORMING ARTS

- Black Box
- CTE Maker Space
- Engineering Robotics
- Industrial Technology
- Math Classrooms
- Metal Manufacturing
- Performing Arts
- Science Classrooms
- Woods/Construction



*“In addition to teaching self-expression, the performing arts help society as a whole in self-knowledge and understanding.”*

*The American Musical Theatre Academy*

NOTES



SE 52nd AVENUE

**EAST WING**  
**MEDIA CENTER &**  
**CLASSROOM SPACES**

- Administration
- College and Career Center
- Collaboration Space
- Common Spaces / Courtyard
- Computer Lab
- Conference Rooms
- Counseling
- Dining Room
- Extended Learning
- General Education Classrooms
- Kitchens
- Law Center
- Lecture Halls
- Life-skills
- Media Center
- Speech Pathologist



*“I am so excited to finish  
my journey here, it is  
beautiful.”*

*Maya Horten  
FHS Student, Class of 2018*

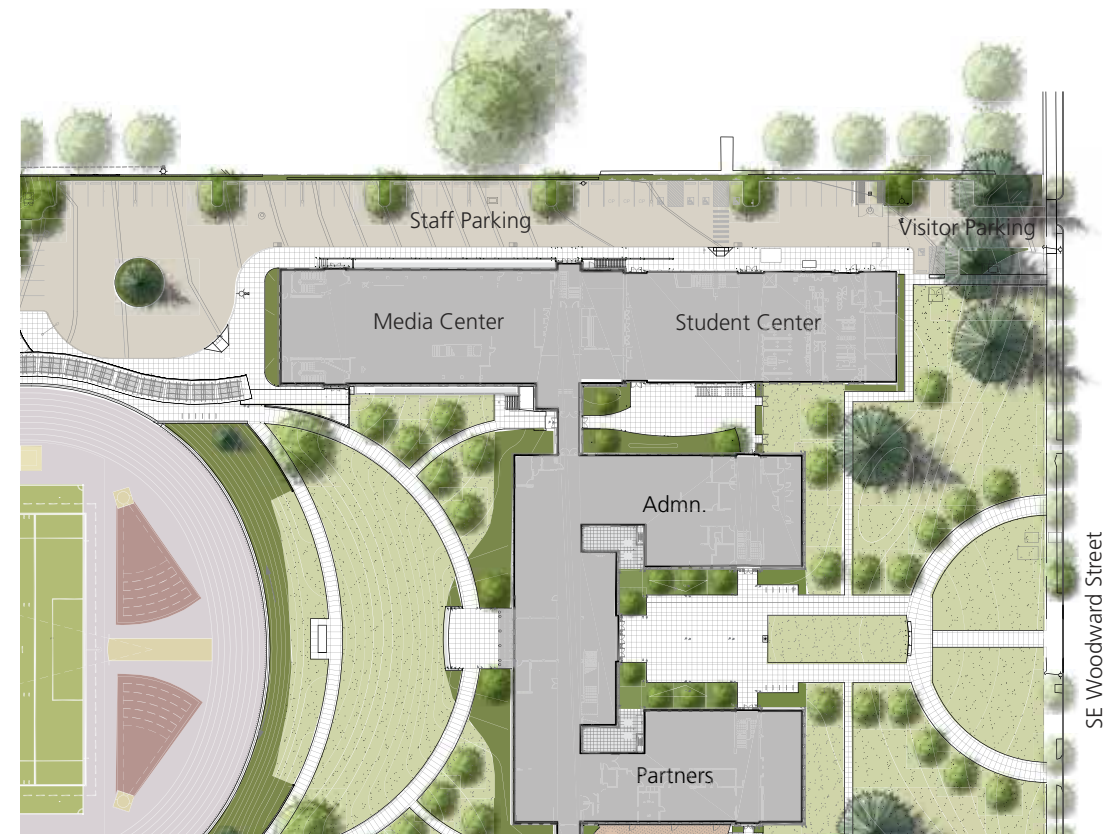

NOTES

---



---



---



---



---

## GYMNASIUM BUILDING

- Athletics
- Biomedical
- Culinary Arts
- Extended Learning
- Gymnasium
- General Education Classrooms
- Synthetic Track & Field
- Trainer Facilities
- Weight Room



*“To uncover your true potential you must first find your own limits and then you have to have the courage to blow past them.”*

*Picabo Street*



## NOTES

---

---

---

---

---

---

---

---

---

---

*“Our new school allows us to provide students  
with a facility worthy of learning in the  
21st Century.”*

*Chris Frazier  
FHS Vice Principal*

## PROJECT TEAM

OWNER	PORTLAND PUBLIC SCHOOLS
PROJECT MANAGEMENT	HEERY INTERNATIONAL, INC.
ARCHITECT	DOWA / IBI GROUP + SERA
GENERAL CONTRACTOR	SKANSKA
CONSTRUCTION MANAGEMENT	HEERY INTERNATIONAL, INC.
CIVIL ENGINEERING	KPFF
MECHANICAL/PLUMBING	PAE
ELECTRICAL	REYES ENGINEERING
PLUMBING ENGINEER	PAE
LANDSCAPE ARCHITECT	MEYER REED
THEATER CONSULTANT	PLA
ENVIRONMENTAL	KELSAY
ACOUSTICAL	GREENBUSCH
BUILDING ENVELOPE	MORRISON-HERSCHFIELD
STRUCTURAL ENGINEER	KPFF
SCHEDULING	SCHEDULING AND INFORMATION SERVICES, INC.
FOOD SERVICE	HALLIDAY

